

Date: Friday, September 30, 2022

Detail Plans for Sorvig LLP 468 Lined Waterway or Outlet Pennington County, Minnesota

INDEX OF DRAWINGS	
Sheet Number	Title
1	Cover Sheet and Quantities
2	Plan View, Profiles, Typical Sections, Details, and Notes

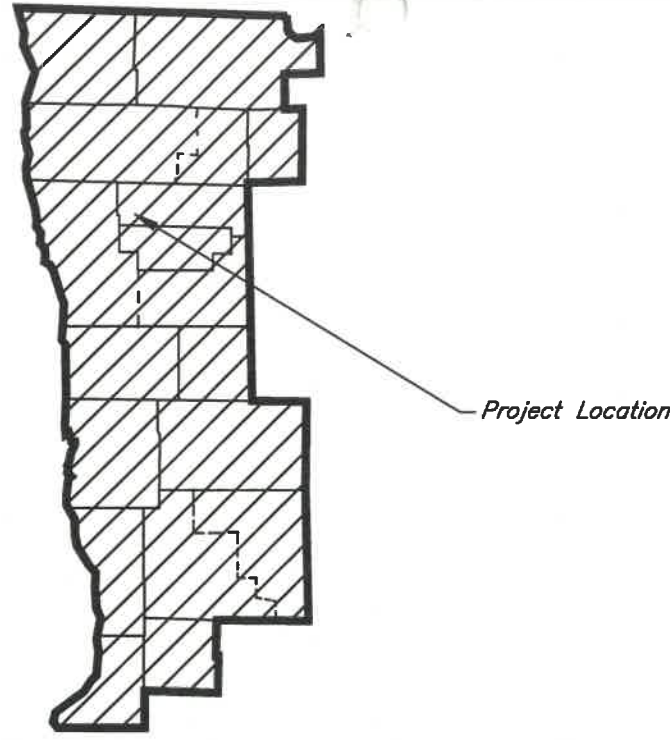

The landowner is responsible for locating and staking all existing tile lines prior to commencing any construction. RRVCSA assumes no responsibility for damage to existing tile lines.

Minnesota specifications for conservation practices apply for all materials and construction work. These specifications are part of this plan.

The Owner shall notify the Engineer and SWCD at least two (2) working days prior to the start of construction.

NOTE: Changes in the drawings or specifications must be authorized by the owner and the NRCS, RRVCSA, or SWCD representative with the proper approval authority.

The owner is responsible for obtaining land rights and local, state, and federal permits or other permission necessary to perform and maintain the practice.

Before start of construction, the owner(s) of any utilities involved must be notified. The excavator is responsible by state law for giving notice by calling "Gopher State One-Call" at (651) 454-0002 (twin cities metro area) or (800) 252-1166 (all other locations) at least 48 hours prior to any excavation.

GSOC Number _____

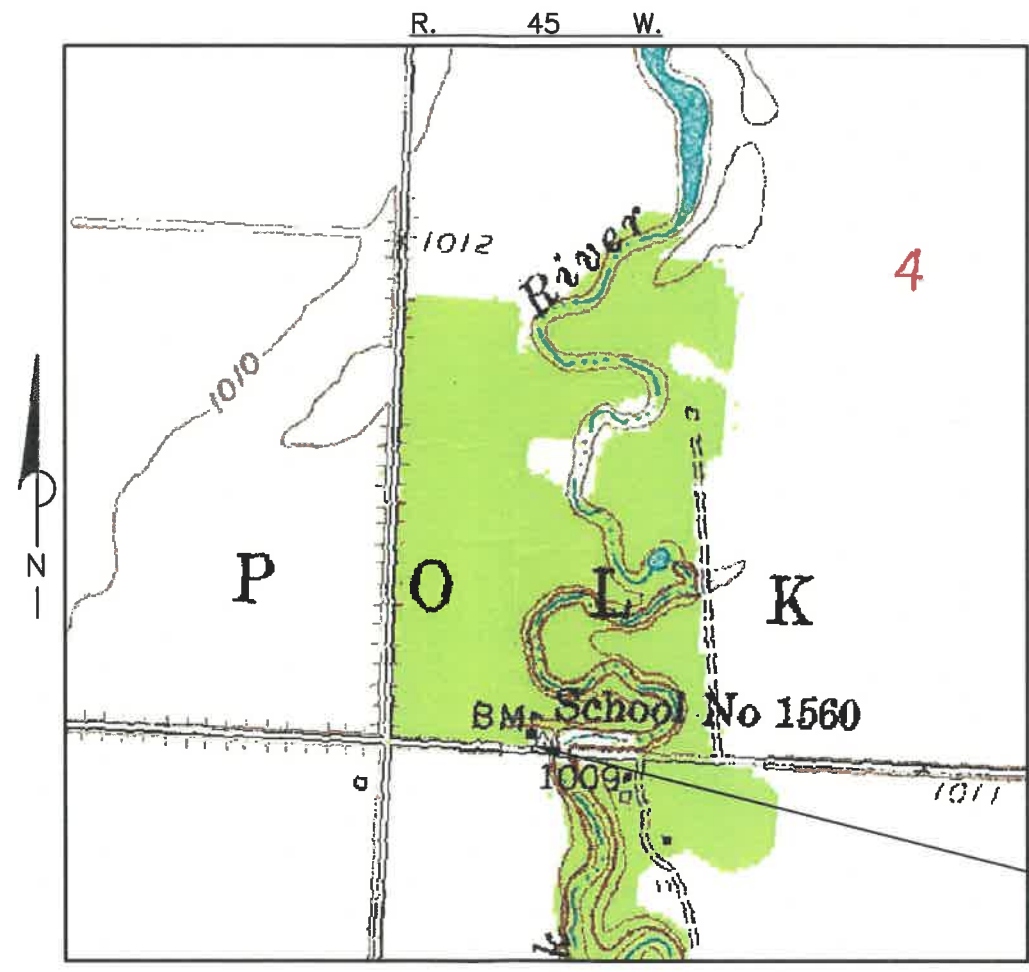

SUMMARY OF ESTIMATED QUANTITIES			
No.	Quantity	Unit	Item
CS001	1	LUMP SUM	Mobilization
CS005	1	LUMP SUM	Pollution Control
CS002	1	LUMP SUM	Clearing and Grubbing
CS021	136	CU YD	Excavation - Common, Waterway Shaping
CS023	115	CU YD	Compacted Earthfill, Repair Erosion
CS095	390	SQ YD	Geotextile, Geotex 701 or Equivalent
CS061	95	CU YD	Random Riprap, MnDOT Class II
CS006	1	LUMP SUM	Seeding and Mulching

- NOTES:
1. CV - Compacted Volume
 2. (P) - Denotes a plan quantity with no additional compensation.
 3. Geotextile Class 1 - Non Woven, shall be overlapped and anchored 18in. minimum along sides and 24in. minimum on the ends.
 4. Seed and Mulch all disturbed areas.

I have reviewed and understand the plans and specifications and agree to complete the work accordingly. Failure to meet these plans and specifications may jeopardize any cost share applied for. I understand that it is my responsibility to secure all necessary permits and licenses, and to complete the work in accordance with all local, state, and federal laws. Modifications of these plans or specifications must be approved by the Engineer before installation. I assume responsibility for negotiations and agreements with the contractors.

LEGEND	
SOIL BORING	● TH
BENCH MARK, TEMPORARY	● TBM
CONTOUR	
CONTOUR, INDEX	---1100---
COMMON EXCAVATION	⊕
EARTHFILL, CLASS C COMPACTION	⊙
EDGE OF FIELD	—+—+—+—
EDGE OF TREES	~ ~ ~ ~ ~
SECTION	
DRIVE/TRAIL	—+—+—+—
APPROX. PROPERTY LINE	— PL — PL —
ROCK RIPRAP	⊠
FLOW DIRECTION	→

NOTE: HORIZONTAL/VERTICAL ACCURACY UNKNOWN
 HORIZONTAL DATUM:
 UTM ZONE 15 NORTH, NAD 1983
 VERTICAL DATUM:
 NAVD 88, GEOID 18

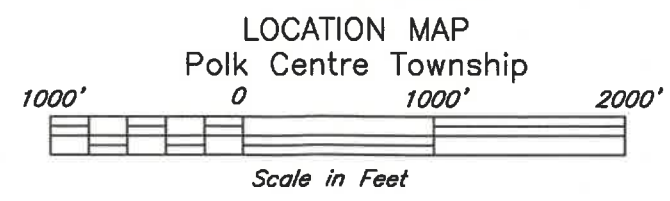

CONSTRUCTION CERTIFICATION

This installation meets NRCS standards and specifications. Yes No

Inspected by: _____
 Certified by: _____
 Date: _____

COOPERATORS SIGNATURE _____ DATE _____

No.	Revision	Date	By

COVER SHEET 468 Lined Waterway or Outlet Pennington Soil & Water Conservation District Pennington County, Minnesota Sorvig LLP	Red River Valley Conservation Service Area Designed <u>Logan Handyside</u> Date <u>8/29/2022</u> Drawn <u>LAH</u> Date <u>8/29/2022</u> Checked <u>LAH</u> Date <u>9/30/2022</u>	I hereby certify that this plan, specification, or report was prepared by me or under my direct supervision and that I am a duly Licensed Professional Engineer under the laws of the state of Minnesota. Signature: <u>Logan Handyside</u> Date: <u>9/30/2022</u> License # <u>55889</u>	File Name Sorvig.dwg Eng. Job Class III Sheet 1 of 2
---	--	--	--

Date: Friday, September 30, 2022

BENCH MARK DESCRIPTIONS

TBM #1 ELEV = 1008.00'
TOP OF 24" CMP ON SOUTH SIDE OF 110TH ST. SW

NOTE: HORIZONTAL/VERTICAL ACCURACY UNKNOWN

HORIZONTAL DATUM:
UTM ZONE 15 NORTH, NAD 1983
VERTICAL DATUM:
NAVD 88, GEOID 18

LEGEND

BENCH MARK, TEMPORARY  TBM#1
CONTOUR  90
CONTOUR INDEX 

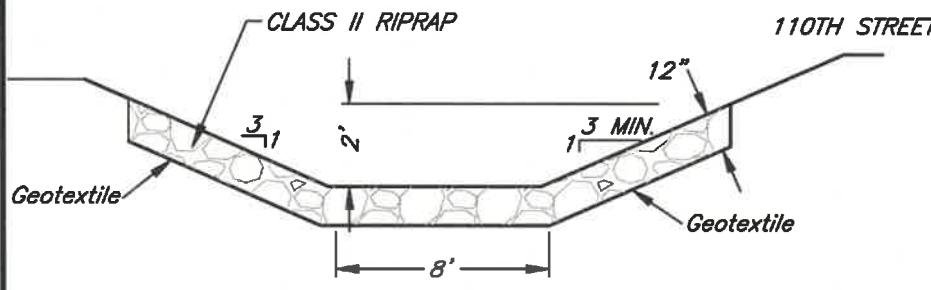
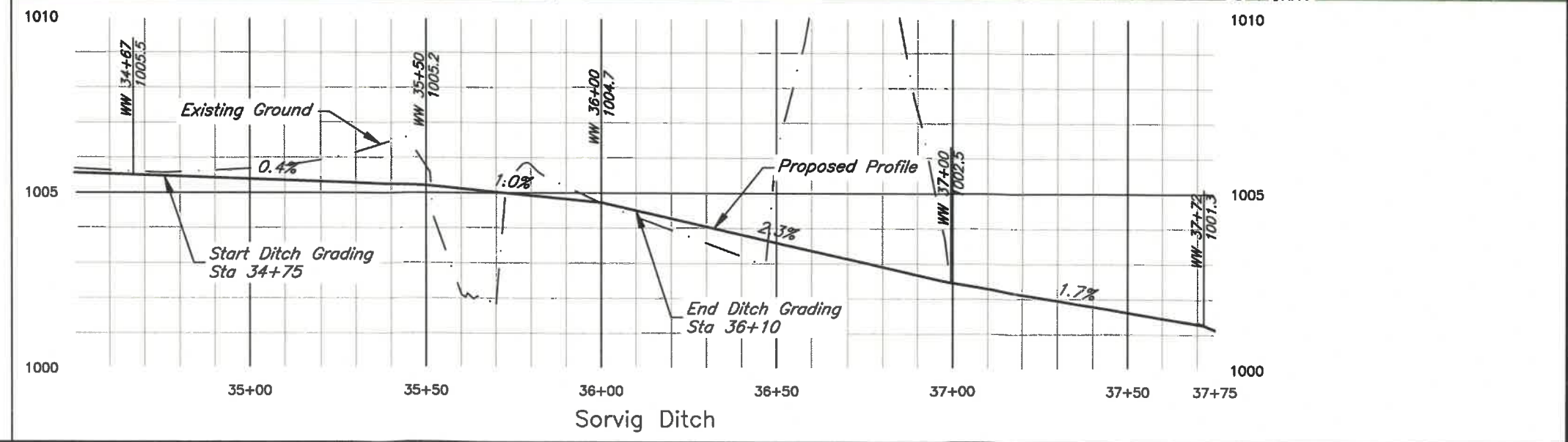
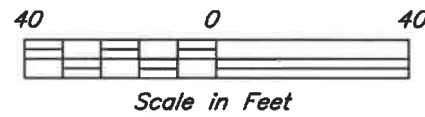

TYPICAL RIPRAP DITCH SECTION
(Not to Scale)

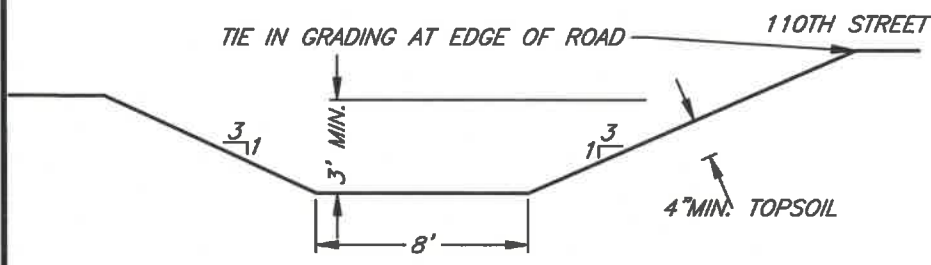

TYPICAL DITCH SECTION
(Not to Scale)

- Notes:
1. Ditch Grading consists of shaping, repairing, and regrading existing eroded ditch section to proposed typical section and profile shown in the plans.
 2. Outside bend of ditch shall have riprap extend up the inslope an additional 2'. Place riprap around existing culvert outlet.
 3. Erosion control measures must be put in place to prevent sediment from moving downstream of the construction site until excavation operations are complete and ditch is stabilized.
 4. Place Spoil where it will not interfere with surface water flow into the waterway.
 5. Do not disturb road adjacent to project site.

No.	Revision	Date	By

CONSTRUCTION PLAN
468 Lined Waterway or Outlet
Pennington Soil & Water Conservation District
Pennington County, Minnesota
Sorvig LLP

Red River Valley Conservation Service Area
Designed Logan Handyside Date 8/29/2022
Drawn LAH Date 8/29/2022
Checked LAH Date 9/30/2022

I hereby certify that this plan, specification, or report was prepared by me or under my direct supervision and that I am a duly Licensed Professional Engineer under the laws of the state of Minnesota.
Signature: Logan Handyside Date: 9/30/2022 License # 55889

File Name Sorvig.dwg
Eng. Job Class III
Sheet 1 of 2